

linear dimension(Tolerances Standard GB/T 14486-2008)								—	\square	\perp
variable range	to 6	over 6 to 10	over 10 to 30	over 30 to 60	over 60 to 100	over 100 to 160	over 160 to	to 10	over 10 to 100	over 100 to
tolerance	±0.20	±0.30	±0.50	±0.70	±1.00	±1.30	±1.60	0.10	0.30	0.60

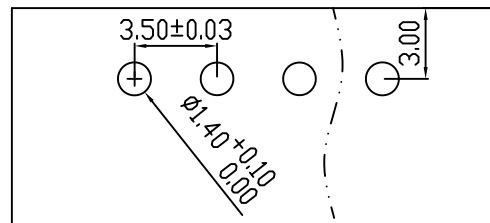
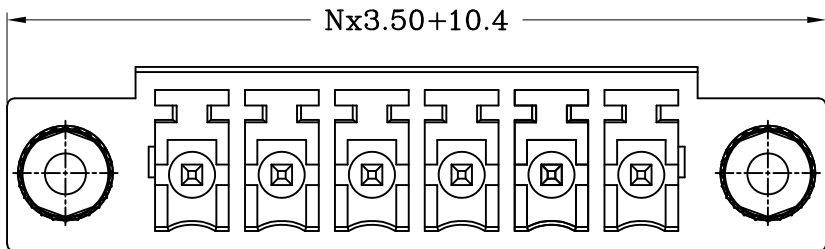
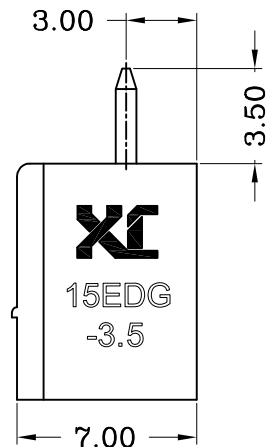
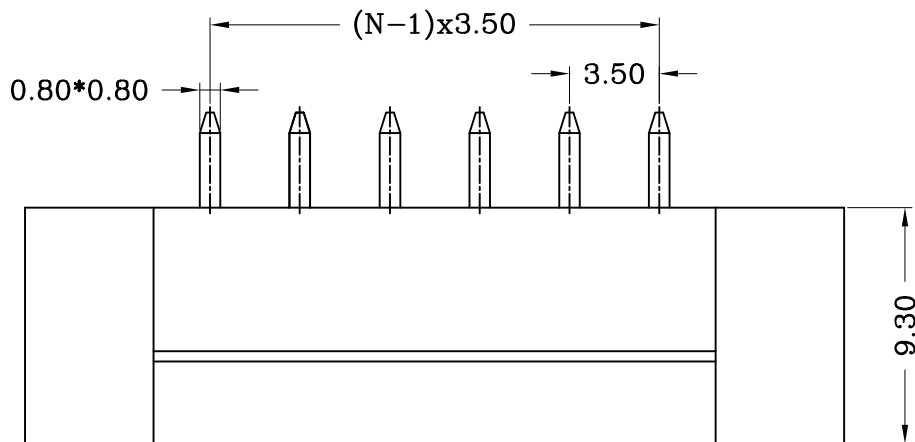

PCB LAYOUT

REVISION RECORD				
REV.	DESCRIPTION	ECN NO.	APPROVE	DATE
A	新发行		YXW	2021.2.25

UL/CUL 技术参数 UL/CUL Technical Data			
等级 Use Group	B	C	D
额定电压 Rated Voltage (V)	300	-	300
额定电流 Rated Current (A)	8	-	10
接线范围 Wire Range 单/多芯线 Solid/Stranded (AWG)			
耐电压 withstanding VOLTAGE	1600V/Min		
IEC 技术参数 IEC Technical Data			
过电压类别 Overvoltage Category	III	III	II
污染等级 Contamination Class	3	2	2
额定电压 Rated Voltage (V)	-	160	320
额定电流 Rated Current (A)	-	7	7
额定冲击电压 Impulse Withstand voltagea (KV)		2.5	2.5
导线截面积 Conductor cross section 硬质/柔性导线 Solid/flexible (mm ²)			
材料 Material			
绝缘材料 Insulation Material	PA66		
阻燃等级 Lmflammability	UL94V-0		
导体材料 Contactor Material	铜合金 Copper alloy		
导体表面镀层 Contactive Coating	镀锡		
一般参数 Other Data			
间距 Pitch (mm)	3.5		
极数 Poles (P)	2-24		
剥线长度 Stripping Length (mm)	-		
螺丝 Screw/扭矩 Torque (Max) (N.M)	-		
工作温度 Operating temperatur (°C)	-40--+105		
引针尺寸 Pin Dimensions (mm)	3.5		
PCB板孔径 PCB Hole Diameter (mm)	1.4		

DES.	CLB	DATE	2021.2.25	单位/UNITS	MM	时间/SIZE	A4	比例/SCALE	1:1	第三视角/THIRD ANGLE PROJECTION	版本/REV	A	
CHK.	LF	DATE	2021.2.25	宁波市旭骋电子有限公司 NINGBOSHI XUCHENG ELECTRONIC CO., LTD								名称/TITLE	XC15EDGVM-3.5
APP.	YXW	DATE	2021.2.25										